

GTS21FGK

GE® 20.8 Cu. Ft. Top-Freezer Refrigerator

DIMENSIONS AND INSTALLATION INFORMATION (IN INCHES)

OVERALL DIMENSIONS	Height to top of hinge (in.) A	67
	Height to top of case (in.) B	66-3/8
	Case depth without door (in.) C	28
	Case depth less door handle (in.) D	32-1/4
	Case depth with door handle (in.) E	33-7/8
	Depth with fresh food door open 90° (in.) F	60-1/2
	Width (in.) G	31-1/4
	Width with door open 90° with door handle (in.) H	32-1/2
AIR CLEARANCES	Each side (in.)	1
	Top (in.)	1
	Back (in.)	2

FRONT VIEW

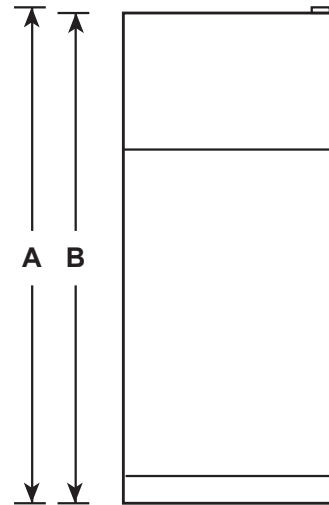

TOP VIEW

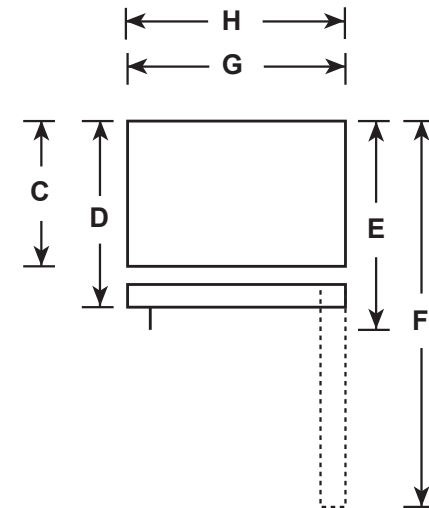

For answers to your Monogram, GE Café™ Series, GE Profile™ Series or GE Appliances product questions, visit our website at geappliances.com or call GE Answer Center® Service, 800.626.2000.



GTS21FGK

GE® 20.8 Cu. Ft. Top-Freezer Refrigerator

FEATURES AND BENEFITS

LED interior lighting in fresh food section - Spotlights foods inside making them easy to see

Dairy bin - Provides convenient storage for dairy items

Spillproof glass shelves - Help contain spills for ease of cleaning

Gallon door storage - Deep bin handles large containers in the door and frees up valuable shelf space

Adjustable glass freezer shelf - Provides the flexibility to organize your frozen food items

Equipped for optional icemaker - Easily accommodates the installation of an icemaker

High-gloss finish - Enjoy a polished appearance that stands out in any kitchen

Model GTS21FGKWW - White

Model GTS21FGKBB - Black

